



Sandra M. Strand

BS (Interior Design), MBA, LEED BD+C, NCIDQ, CID

Digital Portfolio

These corporations use raw materials to create end products and then market these products to the consumer. The design of the project enforces the product and it's branding with every visit to the facility. ROLES: Project Principal for programming, design, and project management.

CILIENTS include: Coca-Cola, Dyson, Lee Jeans, Mary Kay, Madame Tussaud's, SONY, and VF.

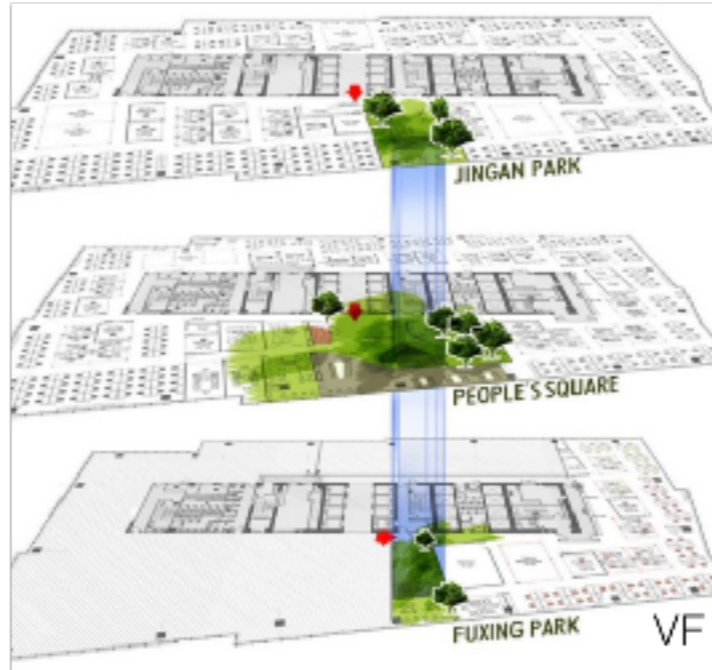

Most of these corporations are focused on new technologies. The facilities design must attract, retain, and inspire employees to continually innovate. ROLES: Strategic consulting and Project Principal for interior design and project management. Large corporations such as Cisco Systems and Nortel Networks were global clients with master service agreements so many projects in multiple locations were done for these corporations.

CLIENTS include: Bloomberg, Booking.com, Cisco Systems, GT Solar, Hewlett-Packard, Honeywell, KONE Elevators, LSI/Avago, Nortel Networks, Philips, United Technologies, and WeWork.

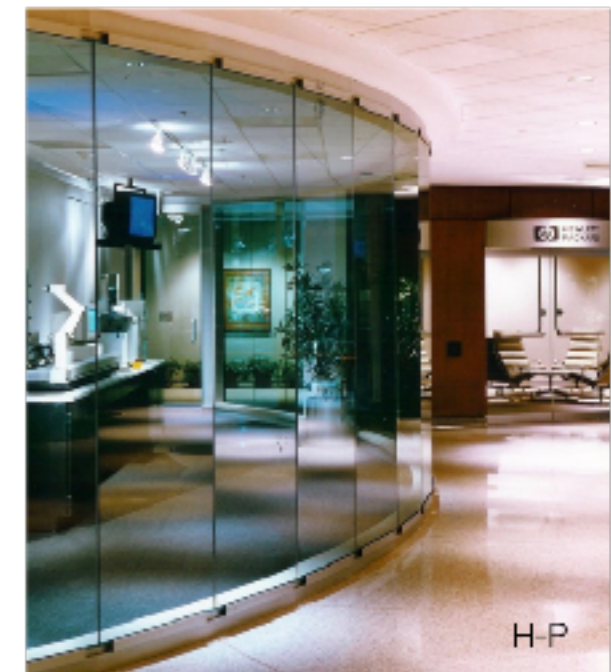

The chemical and pharmaceutical industry processes raw materials into products. Often, the products become a component of a customer's product. Laboratory design is a key design element of these projects. ROLES: Project Principal for programming, design, and project management. Coordination of interior design with lab planners.

CLIENTS include: Dow Chemical, Givaudan, and Infineum.

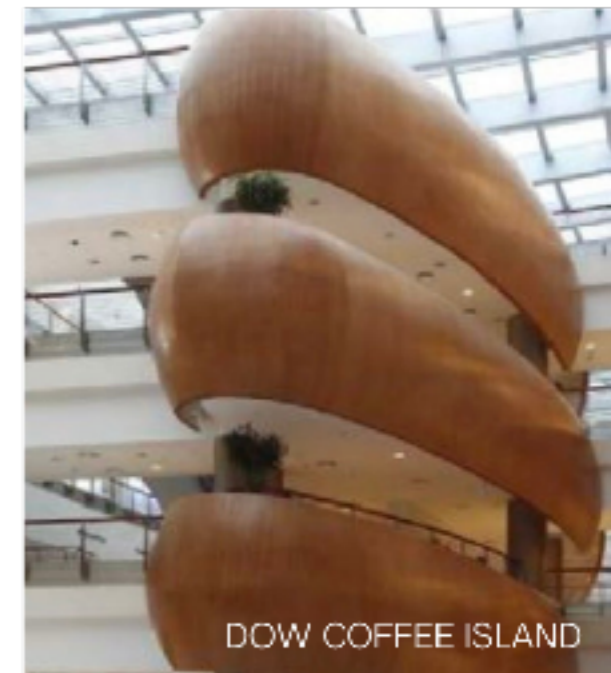

These firms are selling talent, technology, and data on a time or end-product basis. They deliver solutions with measurable outcomes. ROLES: Project Principal for design and project management. Developed specialty in law firms and was involved in marketing these projects.

CLIENTS include: Bain, Best & Flanagan, Dewey & LeBouef, Ernst & Young, Finnegan, Fulbright & Jaworski, Gray Plant Mooty, Lang Pauly & Gregerson, McKinsey, Mindshare, Spencer Stuart, Towers Perrin, William Morris and Winson & Strawn.

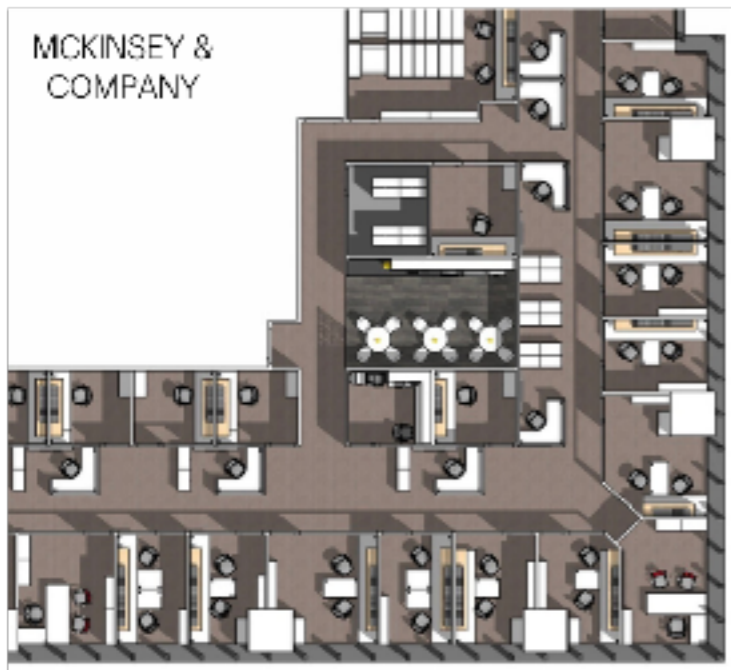

These corporations manage money and are providing financial goods to consumers and businesses such as banking, investing, and insurance. ROLES: Project Principal for interior design and project management.

CLIENTS include: ADP, AIG, Bank Bahari, China Banknote, DBS, DNV-GL, Fortress Investments, and Prudential Mortgage.



Control Rooms are the most expensive part of an infrastructure project. They function as 'central traffic control area' for all information and communications and are a key marketing tool. Typically, executives have high finish meeting rooms overlooking the control room used for major client presentations, executive meetings, and public relations events to highlight the features of the system. ROLES: Specialty Consultant and Principal for design and management of Control Rooms- coordinating with other consultants such as lighting, audio-visual, acoustic and console furniture. This work became a personal specialty with 15 centers completed. CLIENTS include: Amtrak, Beijing Rail, China Merchants, China Telecom, Industrial & Commercial Bank of China (ICBC), Koch Refinery, Lanzhou Rail, Lower Colorado River Authority, NSP/Xcel Energy, Shanghai Power, Shenyang Rail, Sichuan Power Tren Urbano, UnionPay, and Wuhan Rail.

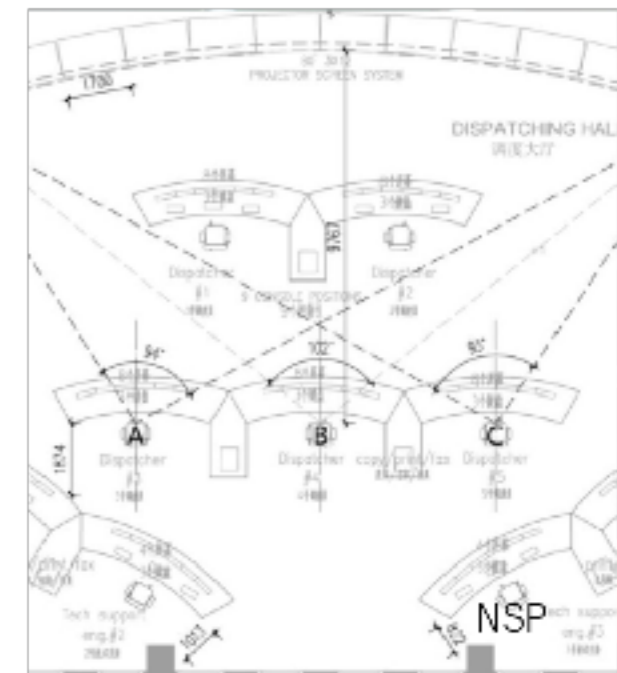

These specialized institutions provide instruction and training. For the design team, the focus is on enhancing the ability to learn. Included in this category are schools, colleges, universities, and training centers. ROLES: Strategic consulting and programming. Interior design and finishes. Worked on interior design for the new University of Minnesota- Carlson School while also completing my MBA.

CLIENTS include: Arizona State University- Business School, British Council, Concordia International School, Dulwich International School, Hunan International Economics University, Iowa State University- Engineering & Research, and University of Minnesota- Carlson School.

